

# Basic tower aluminium

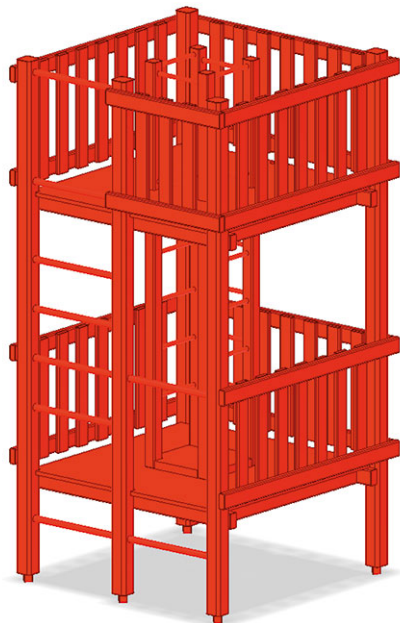

Device line Aluminium

Article B-05-120

Basic aluminium tower for platform heights 15/200 cm, base area 170 x 170 cm, with aluminium posts, external rung ascent from the ground to the first platform, internal rung ascent from the first to the second platform, without pyramid roof.



**CHF 7'500.-**  
(excl. VAT)

 Fall height	200 cm
 Assembly time	1 h
 Installers	2