

# Basic tower aluminium

Device line Aluminium

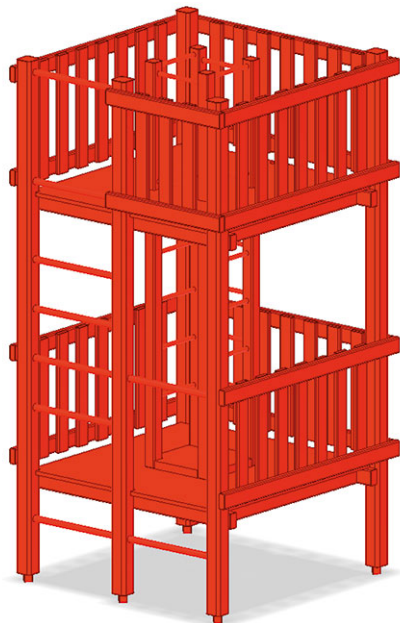

Article B-05-130

Basic aluminium tower for platform heights 70/245 cm, base area 170 x 170 cm, with aluminium posts, external rung ascent from the ground to the first platform, internal rung ascent from the first to the second platform, without pyramid roof.



**CHF 7'725.-**

(excl. VAT)

 Fall height	245 cm
 Assembly time	1 h
 Installers	2